

MI DRG. NO.

TF150AB11D

REV.

TF150AB11**D****HIGH POWER ALN TERMINATION**

SPECIFICATIONS

FILE: TERMOUT

POWER MAX
(WATTS):

150 CW

RESISTANCE

50 OHMS \pm 5%

FREQUENCY

VSWR

DC-2.0GHz

1.2 :1

RoHS COMPLIANT (BeO FREE)

DIMENSIONS IN BRACKETS INDICATE [mm]

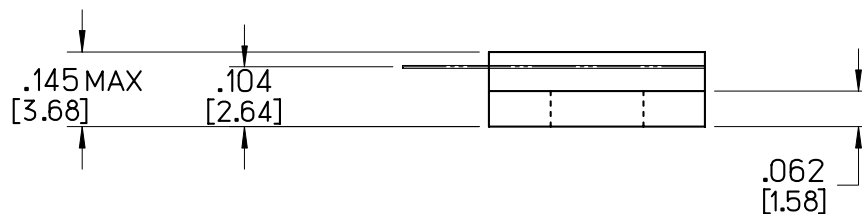
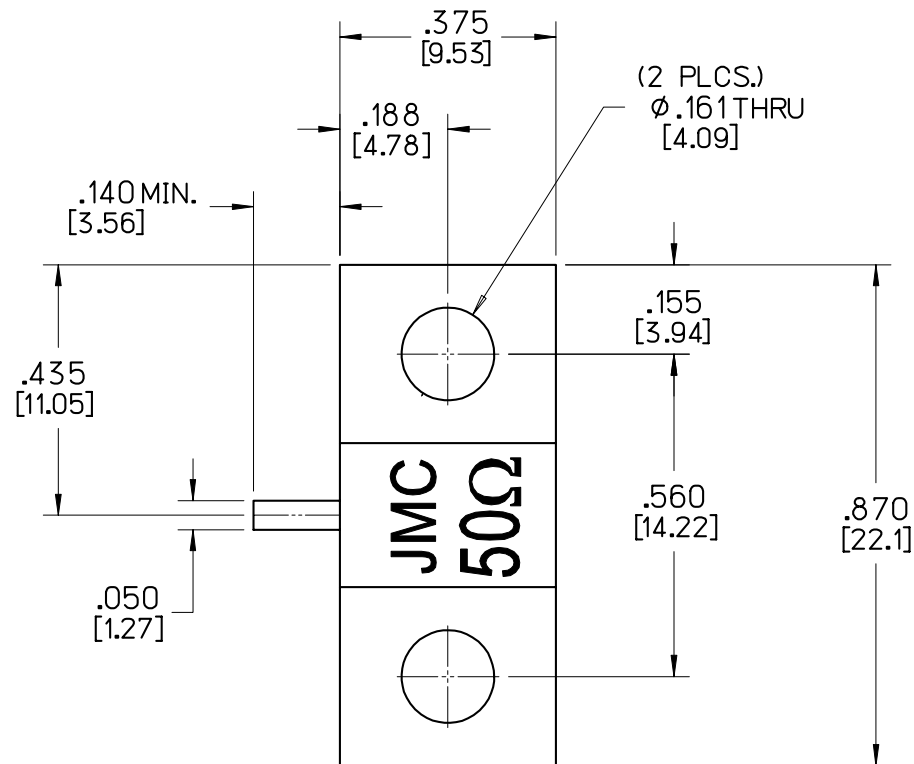

POWER DERATING

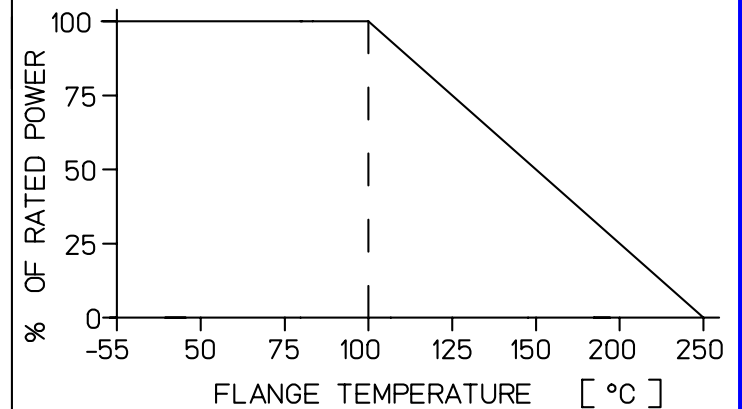

D	02/25/09	MAI	MAI	MAI	000751
C	10/30/07	MLD	MAI	MAI	000607
B	10/09/07	SAF	SAF	MAI	000600
A	10/19/06	MLD	-	-	000457
LEVEL	DATE	DRN.	CHK.	APP.	ECN

REVISIONS

DRN.	CHK.	APP.	SCALE
MLD	MAI	MAI	3" = 1"
DATE	DATE	DATE	.XX \pm .015
10/19/06	10/19/06	10/19/06	.XXX \pm .010

**JOHANSON MANUFACTURING CORPORATION**

ROCKAWAY VALLEY ROAD, BOONTON, N.J. 07005 (973)334-2676 FAX (973)334-2954
ELECTRONIC ACCURACY THROUGH MECHANICAL PRECISION

PROPRIETARY INFORMATION CONTAINED NOT TO BE USED WITHOUT JOHANSON MANUFACTURING CORPORATION APPROVAL